

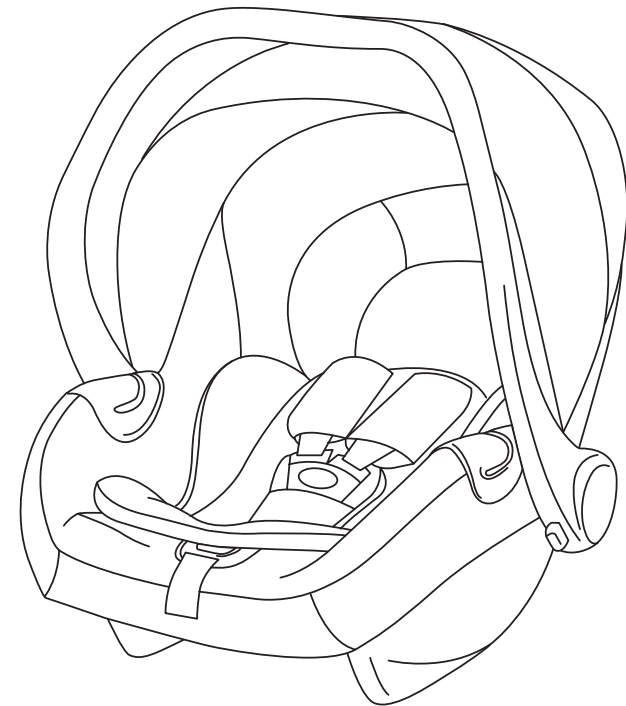

FRANCE DESIGNED

PLUTO

Carseat
USER MANUAL



www.jikelbaby.com

IMPORTANT
Retain for Future Reference & Read Carefully



0-13Kg



Content

<i>1 Application scope</i>	02
<i>2 Important notes</i>	02
<i>3 Vehicle related notes</i>	03
<i>4 Assembly indicator</i>	04
<i>4.1 Handle adjustment</i>	05
<i>4.2 Seat cushion and Canopy</i>	05
<i>4.3 Baby fixation and notes</i>	06
<i>4.4 Y-belt position adjustment</i>	06
<i>4.5 Installation in vehicle</i>	07
<i>4.6 Check the belt and make sure its route goes on correctly</i>	07
<i>5 Fabric covers Notes</i>	08
<i>5.1 Remove the canopy and fabric cover</i>	08
<i>5.2 Fabric cover installation</i>	09
<i>6 Maintainance</i>	09
<i>6.1 Attention</i>	09
<i>6.2 Cover cleaning</i>	10

1.Application scope

Certificated by ECE R44/04 , this baby safety seat is applicable for Group 0+ infants.

<i>Baby safety seat</i>	<i>Group</i>	<i>Range of baby weight</i>
<i>BC100B</i>	<i>0+</i>	<i>0-13kg</i>

Certification

- This baby safety seat is designed and tested with the European Children Rstraint System standard (ECE R44/04) . The certification stamp E mark (in the round circle) with approval number and (in the ellipse circle) can be found on the labels (in the bottom side of this seat)
- Any modification of this seat by you will lead to invalidity of the certification. Nobody is authorized to modify baby safety seat unless the baby safety seat manufacturer.

2.Important notes

To protect the baby

- **Important!** Due to problem at birth, some baby might be underweight, please confirm with the doctor before using this seat.
- **Important!** Do not use any accessory which is not shown in this instruction.
- **Important!** Do not fix this seat in ways that are not shown in this instruction.

Caution

Please read this instruction carefully and keep it well for future reference unless you will not use this product any more. If this product is given to another person, please enclose this instruction along with the product. Not following this instruction to

Operate the product may cause safety risk and put your child into dangers.

- Please follow the instruction to install this product. Make sure all parts are correctly assembled or stored. When using on a normal vehicle, please make sure the baby car seat is not stuck by car seat or vehicle door.
- The car belt and baby car seat harness system must be fastened tight and adjusted according to the child's height. Not twisting of any strap.
- The waist strap of car belt must be used correctly. Make sure the waist strap can restraint the child's pelvis properly.
- After any impact or collision caused by a traffic accident, the baby car seat must be changed to a new one.
- If no fabric covers the surface of baby car seat, please do not expose the baby car seat into direct sunlight, or the child might be burned by the hot product surface.
- Do not left you child alone on the baby car seat without any guardian.
- The luggage and objects which can cause injuries during an accident must be stored properly.
- Modified and uncertified products are dangerous. Products without manufacturer's instruction are also dangerous.
- Baby car seats without fabric cover are forbidden to use. The fabric cover material must not be other materials other than the manufacturer's recommendation. The fabric material will influence the overall seat performance.
- Additional connection point is forbidden. Use the connection points indicated by the instruction only. Any doubt on the connection point, please consult with the manufacturer.

⚠ To protect passengers on board

- All heavy or sharp items must be fixed well.
- All passengers must fasten their seat belts.
- Make sure the baby safety always fixes well even no baby inside.

3.Vehicle related notes

● Use 2-point car belt to fix your baby safety seat may lead to severe injury or death to your child if crash happened.

● By placing the baby car seat on it, abrasive marks might be found on car seats made of sensitive materials such as silk and leather.



Danger

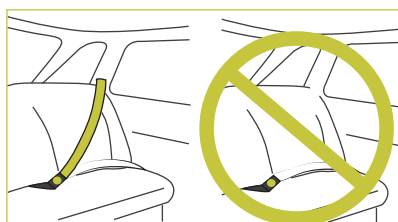

- Do not use this seat on side-facing or rear-facing car seats (1a 1b in drawing below). Only applicable for front-facing car seats. Crash statistic shows that children are safer in back row seats.
- Make sure the baby car seat is not stuck by foldable or movable seat and door.

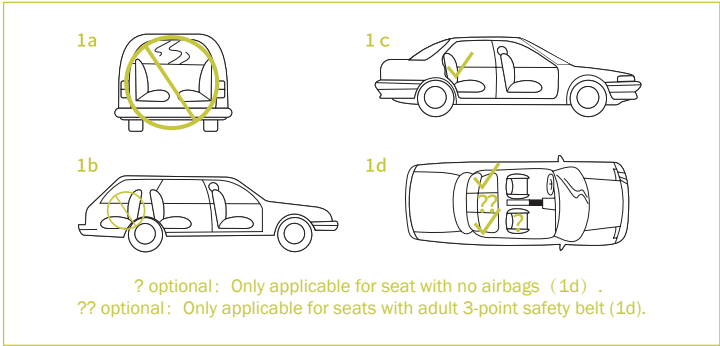

- Put the car belt into lowest position if its height is adjustable.
- Always fix this seat even if no baby inside. Unfastened baby safety seat may injure the passengers on board. Check other objects like luggage or books due to similar reason.
- The belt must be certified by ECE R16/GB14166 or equivalent (please check the label with letter “ e” on seat belts).
- Do not let the child adjust or play with this seat. Check the belt fasten status every time when using this seat.
- Do not use the same car belt together with your child.
- Do not let the child adjust or play with this seat. Check the belt fasten status every time when using this seat.
- Do not use the same car belt together with your child.

4.Assembly indicator

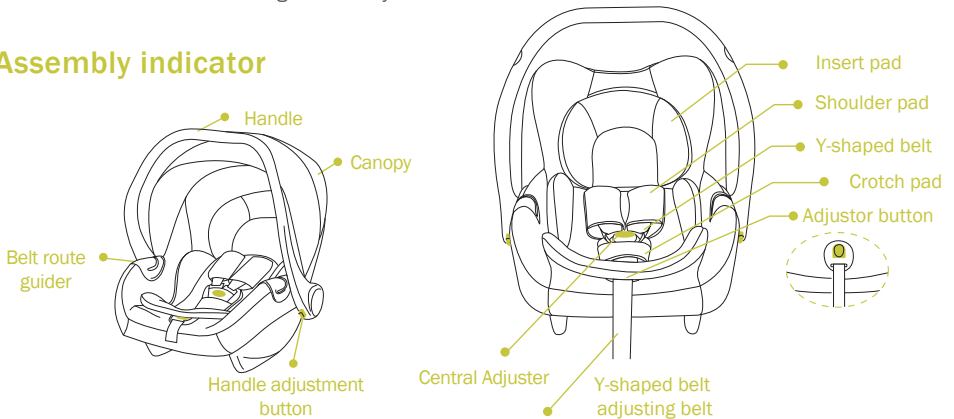

4.1 Handle adjustment

Level adjustment :

- Push the handle adjustment button on both sides (Figure 1 A) at the same time. Then rotate the handle towards the wanted position. Release the button when near the ideal position, adjust the handle slightly until you hear the " click" .

Level description (Figure 2) :

D .Balance position — balance the seat on the ground.

C .Cradle position — function as a cradle.

B .Carrier position — installation in cars or function as a baby carrier.

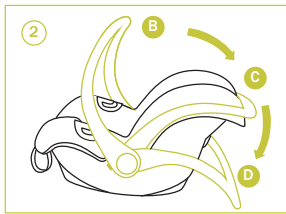
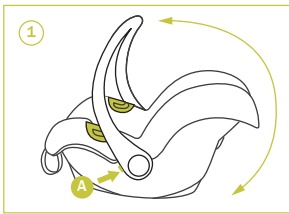

4.2 Seat cushion and Canopy

- The Seat cushion supports and protects your baby's head and back. The waist cushion (Figure 3 E behind the head and back cushion) can reduce the pressure on baby's waist (After your baby grows up, the cushions can be removed to provide more inner space).

- The function of canopy is to prevent the light from shining on children's face. You can choose to use it according to the situation (Figure 4).

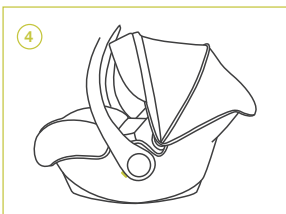

4.3 Baby fixation and notes

Length adjustment:

- Extend the Y-shaped belt—press the adjusting button (Figure 5), mean while stretching out the belt.
Note: Do not put shoulder pad.
- Push the red button on buckle to release Y-shaped belt.
- Put aside the buckle tongues separately (Figure 6).
- Put your baby into the baby safety seat, then put Y-shaped belt onto baby's shoulder gently (Figure 7).
Note: Do not twist or cross Y-shaped belt.
- To lock Y-shaped belt , place the two buckle tongues together properly, then plug it into the buckle slot. A“ click”sound can be heard as a sign of locked (Figure 8) .
Note: the proper loaction of the buckle is near your baby's crotch rather than his/her belly.
- Pull the adjuster strap through the arrow direction (Figure 9) to fasten the Y-shaped belt. The proper tightness is a two-finger space between Y-shaped belt and your baby's chest.

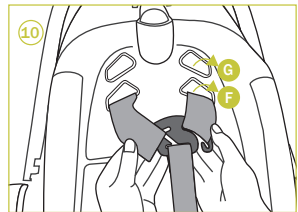
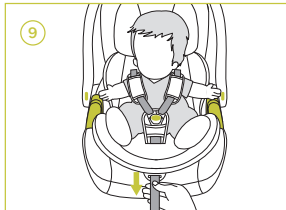
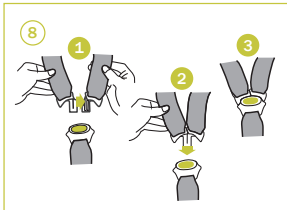
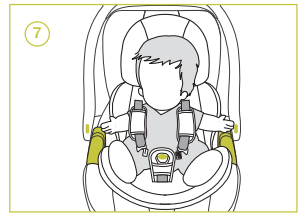
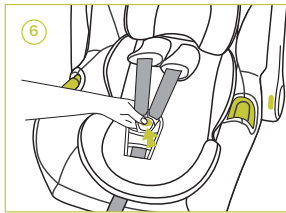
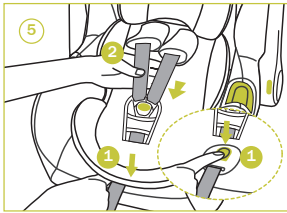

4.4 Position adjustment

Y-belt position adjustment

- As your baby grows up, Y-shaped belt can be removed from the metal splitter plate (on the back side of this seat) and relocated from slot F to slot G (Figure 10).
- Make sure the y-belt is flat and slightly below the baby's shoulders (Figure 11).

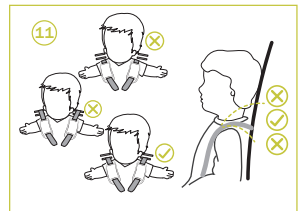

4.5 Installation in vehicle

1) Switch the seat handle to “carrier position”, then place this seat onto the back row car seat near the vertical cushion. The seat should be opposite to the driving direction (Figure 12).

2) Pull out the car belt as long as possible. Place the lap belt over this seat and lock the car belt. Then put the lap belt into the belt route guider(Figure 13).

Note: No twisting or slipping of the car belts.

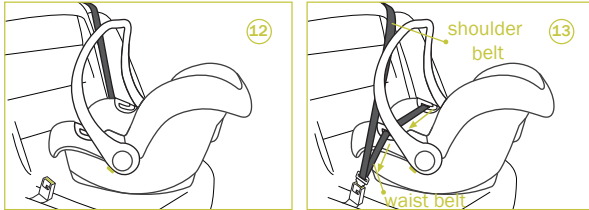

3) Drag the shoulder belt over the baby seat, put the shoulder belt into the blue belt route guider (Figure 14-15).

Note: No twisting or slipping of the car belts.

4) Fasten the car belt (Figure 16)

- push the baby seat to the car seat.
- pull the lap belt horizontally to fasten it.
- Pull the upper shoulder belt to fasten the rest parts and the whole car belt.

Note: Make sure the baby safety seat is fixed well.



4.6 Check the belt and make sure its route goes on correctly

- Do not place your baby car seat too close to the car seat belt buckles (Figure 17-18).

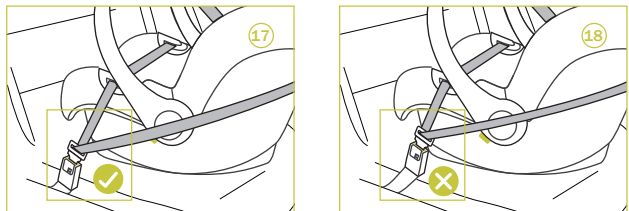

5.Fabric covers notes

5.1 Remove the canopy and fabric cover

- Pull out the fabric cover fixed PP board (Figure 19).
- Loosen the canopy fixed black elastic (Figure 20).

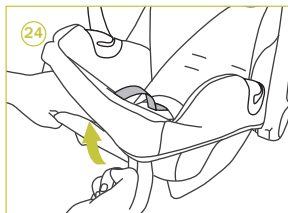
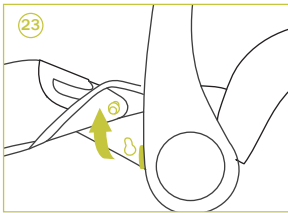
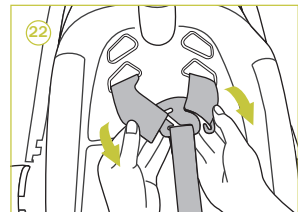
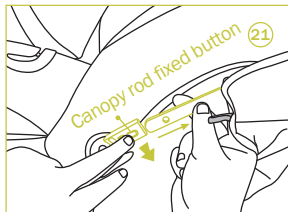
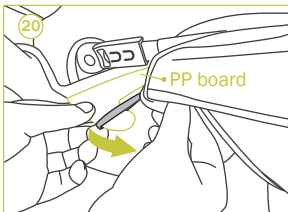
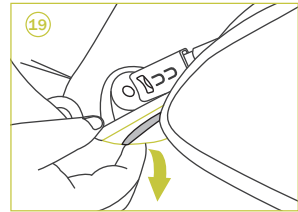

- Using the tool,pull the canopy button outward,pull the canopy rod upward,remove the canopy (Figure 21) .
- Remove the safety belt from the T-buckle (Figure 22).
- Unfasten the fabric cover fixed hook (Figure 23).
- Remove the safety belt guider covers,loosen the edge of the fabric cover,pull the fabric cover upward,remove the fabric cover (Figure 24,25)

5.2 Fabric cover installation

- Put the fabric cover on the plastic shell ,insert the cover along the edge of the car seat shell ,and fix well the safety belt guider cover(Figure 26) Insert the canopy rod into the fixed slot(Figure 27).
- Fix the canopy black elastic on the fabric cover PP board and insert it into the shell edge(Figure 28,29).
- Fix the fabric cover hook, finish the fabric cover installation (Figure 30).

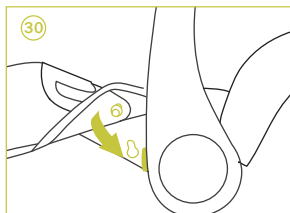
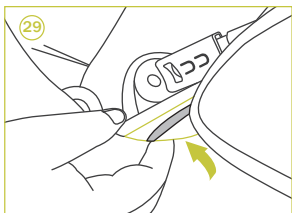
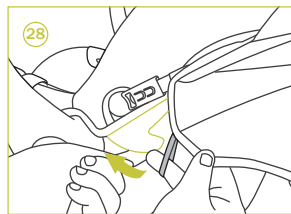
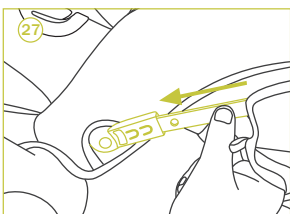

6.Maintenance

6.1 Attention

- Accidents happened when the car speed higher than 10km/h,may cause invisible damage to the baby safety seat.Please change your baby safety seat after crash accident.
- Check all important parts regularly, make sure all mechanism functions properly.
- To avoid damage, make sure no part of this baby seat is stuck by car door , foldable car seat or any other objects.
- Do not lubricate any part with lubricants.
- Store your baby car seat in safe place when not using. Avoid heavy objects, direct sunshine or direct heat on it.

6.2 Cover cleaning

⚠ Baby safety seat must not be used without cover.

- The cover can be removed. Clean the cover in warm water (lower than 30 °C) with mild detergent, dry naturally. No drying.
- Plastic parts can be cleaned with soap water. Do not use strong detergent (for example, dissolvent).
- straps and tethers can be cleaned in soap water.
- Shoulder pad can be removed and cleaned in soap water.

Please read this instruction and relative parts of your vehicle manual. Please follow this instruction when installing and using this baby car seat. Not following this instruction may lead to a severe injury or death to your child. Please keep this instruction in safety place in case of future reading.

Thanks for buying BC100B baby safety seat !

1. This is a “universal” children restraint system (CRS) which is approved to ECE Regulation No. 44, 04 series of amendments , for general use in vehicles and it will fit most, but not all, car seats.
2. A correct fit is likely if the vehicle manufacturer has declared in the vehicle handbook that the vehicle is capable of accepting a "Universal" child restraint for this age group.
3. This child restraint has been classified as "Universal" under more stringent conditions than those which applied to earlier designs which do not carry this notice.
4. Only suitable if the approved vehicles are fitted with 3 point safety-belt approved to UN/ECE Regulation No. 16 or other equivalent standards.
5. If in doubt, consult either the child restraint manufacturer or the retailer.

Note: The picture is for reference only,subject to the actual products please.