



Jikel

UPGO

Group

0+ 1 2 3

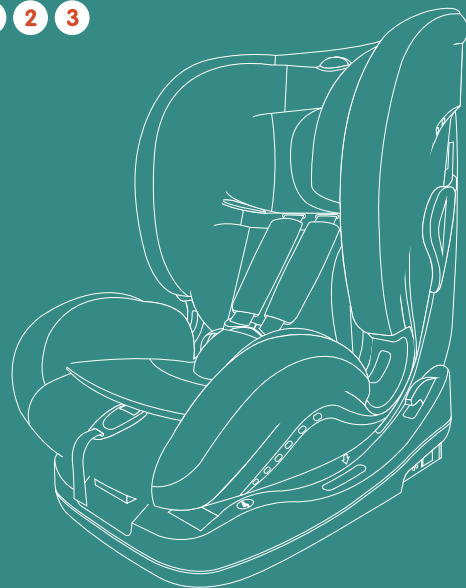

Thank you for trust to our company and products!

1. UNIVERSAL 0+ (0-13kg) : 3-POINT BELT



NOTICE

1. This is a "Universal" child restraint. It is approved to Regulation No. 44, 04 series of amendments, for general use in vehicles and it will fit most, but not all, car seats.
2. A correct fit is likely if the vehicle manufacturer has declared in the vehicle handbook that the vehicle is capable of accepting a "Universal" child restraint for this age group.
3. This child restraint has been classified as "Universal" under more stringent conditions than those which applied to earlier designs which do not carry this notice.
4. If in doubt, consult either the child restraint manufacturer or the retailer.

- ⚠️ Forbid putting children's safety seat in the front row seat with airbag. It might cause serious injury, even death.
- ⚠️ Important – Do not use forward facing installation when body weight is less 9kg (Refer to user manual).
- ⚠️ Only suitable for use in the listed vehicles fitted 3 point/with retractor safety-belts, approved to ECE Regulation No. 16 or GB14166.

2. UNIVERSAL I (9-18kg) : 3-POINT BELT



NOTICE

1. This is a "Universal" child restraint. It is approved to Regulation No. 44, 04 series of amendments, for general use in vehicles and it will fit most, but not all, car seats.
2. A correct fit is likely if the vehicle manufacturer has declared in the vehicle handbook that the vehicle is capable of accepting a "Universal" child restraint for this age group.
3. This child restraint has been classified as "Universal" under more stringent conditions than those which applied to earlier designs which do not carry this notice.
4. If in doubt, consult either the child restraint manufacturer or the retailer.

- ⚠️ Only suitable for use in the listed vehicles fitted 3 point/with retractor safety-belts, approved to ECE Regulation No. 16 or GB14166.

3. UNIVERSAL II+III (15-36kg) : 3-POINT BELT



NOTICE

1. This is a "Universal" child restraint. It is approved to Regulation No. 44, 04 series of amendments, for general use in vehicles and it will fit most, but not all, car seats.
2. A correct fit is likely if the vehicle manufacturer has declared in the vehicle handbook that the vehicle is capable of accepting a "Universal" child restraint for this age group.
3. This child restraint has been classified as "Universal" under more stringent conditions than those which applied to earlier designs which do not carry this notice.
4. If in doubt, consult either the child restraint manufacturer or the retailer.

- ⚠️ Only suitable for use in the listed vehicles fitted 3 point/with retractor safety-belts, approved to ECE Regulation No. 16 or GB14166.

4. SEMI-UNIVERSAL I (9-18kg) : ISOFIX+3-POINT BELT



This Child restraint is classified for "Semi-Universal" use and is suitable for fixing into the seat positions of the following cars:

CAR	FRONT	REAR	
	Outer	Outer	Centre
(Apply to all vehicles with ISOFIX anchroages)	No	Yes	No

Seat positions in other cars may also be suitable to accept this child restraint. If in doubt, consult either the child restraint manufacturer or the retailer.

- ⚠️ Only suitable for use in the listed vehicles fitted 3 point/with retractor safety-belts, approved to ECE Regulation No. 16 or GB14166.

5. SEMI-UNIVERSAL II+III (15-36kg) : ISOFIX+3-POINT BELT



This Child restraint is classified for "Semi-Universal" use and is suitable for fixing into the seat positions of the following cars:

CAR	FRONT	REAR	
	Outer	Outer	Centre
(Apply to all vehicles with ISOFIX anchroages)	No	Yes	No

Seat positions in other cars may also be suitable to accept this child restraint. If in doubt, consult either the child restraint manufacturer or the retailer.

- ⚠️ Only suitable for use in the listed vehicles fitted 3 point/with retractor safety-belts, approved to ECE Regulation No. 16 or GB14166.

WARNING

1. The steel components and plastic components of safety seat have to be fixed by referring to manual, which ensure safety seat not be stuck by car seats and car doors.
Any straps holding the restraint to the vehicle should be tight, that any straps restraining the child should be adjusted to the child's body, and that straps should not be twisted.
3. Any lap strap is worn low down, so that the pelvis is firmly engaged, shall be stressed.
4. It can not be used when it has been subject to violent stresses in an accident.
5. It's dangerous to make any alterations or additions to the chair without the approval of the Type Approval Authority, and it's a danger of not following closely the installation instructions provided by the child restraint manufacturer.
6. The chair should be kept away from sunlight, otherwise it may be too hot for the child's skin.
7. Please do not leave your child in their child restraint system unattended.
8. Any luggage or other objects liable to cause injuries in the event of a collision shall be properly secured.
9. a: The child restraint shall not be used without the cover.
b: The seat cover should not be replaced with any other than the one recommended by the manufacturer, because the cover constitutes an integral part of the restraint performance.
10. The instructions can be retained on the child restraint for its life period.
11. Do not use any load bearing contact points other than those described in the instructions and marked in the child restraint.
12. The rigid items and plastic parts of a child restraint shall be so located and installed that they are not liable, during everyday use of the vehicle, to become trapped by a movable seat or in a door of the vehicle.
13. Any luggage or other objects liable to cause injuries in the event of a collision shall be properly secured
14. Safe driving is the best way to protect children, and children's safety seats can protect children effectively but cannot completely eradicate the harms of car accidents.
15. Please be sure to use the right Group of the children's seats with appropriate methods of application, which refer to the instructions manual of child restraint system. Otherwise, there is potential risk to cause child injuries.
16. The child safety seat must not be positioned anywhere where it is in range of an airbag which is being deployed, otherwise, once accident happened, airbag can hurt your child.
17. If there is mutual interference between the adult safety-belt buckle and the main load bearing contact points on the restraint, it cannot be used. The user shall be advised to contact the child restraint manufacturer if in doubt about this point.
18. Don't use forward facing before the child's weight exceeds 9kg.
19. Rearward facing can not be installed in the position which is equipped with airbag.
20. Keep the instruction for future use.

Table Of Contents

Know Your CAR Seat (Front)	5
Know Your CAR Seat (Opposite).....	6
Selection Criteria for Baby Car Seat.....	7
Group 0+ Installation.....	8
Group I Installation.....	9
Group 0+I: 5-Point Harness Installation.....	11
Group 0+I: 5-Point Harness Removal.....	13
Group II+III Installation and Using method.....	15
Removing the Cover.....	17
Cleaning and Maintenance.....	18

Know Your CAR Seat (Front)

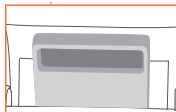
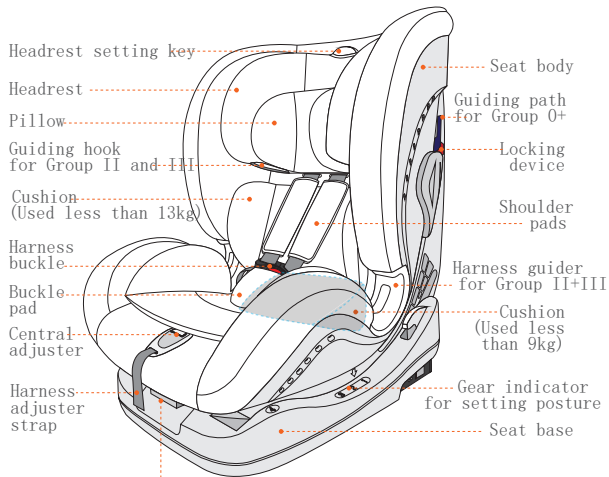

Setting Knob

Know Your CAR Seat (Opposite)

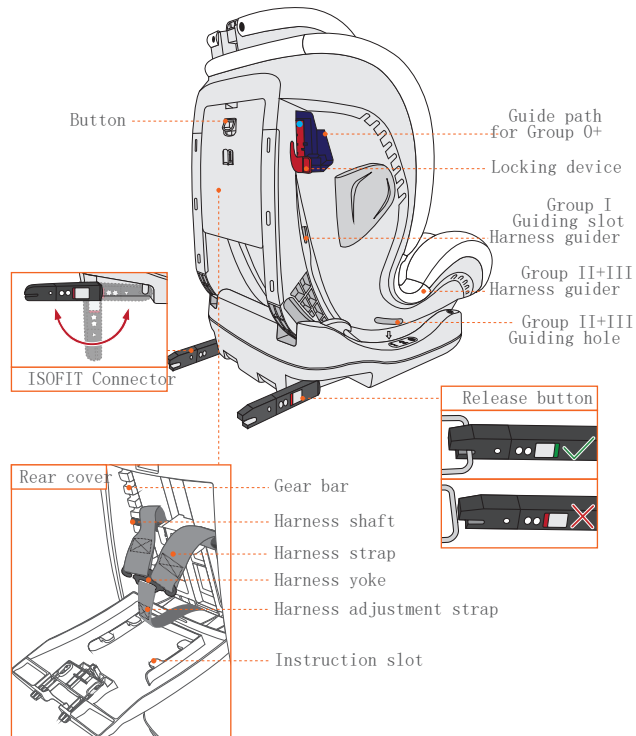





Selection Criteria for Baby Car Seat

Group 0+ Installation



- This type baby car seat is applied to Group 0+/I/II/III and the requirement for weight is from 0 to 36kg. It is suitable for around 0 to 12 year-old children. It only can be suitable to use in the listed vehicles fitted 3 point/with retractor safety-belts, approved to ECE Regulation No. 16 or GB14166.
- Different installation methods should be applied to children in different group. Please follow the below standards to match the right group installation.

Do not use any load bearing contact points other than those

Group	Body weight	Age	Children's restraining system	Installation method	Direction of installation	Requirement for vehicles
0+	0-13kg	0-15 months	5-point harness	vehicle's 3-point seat belt	Rearward Facing 	The vehicle equipped with 3-point belt, and cannot be used if the vehicle seat is equipped with only 2-point belt.
I	9-18kg	9months-4years old	5-point harness	vehicle's 3-point seat belt	Forward Facing 	The vehicle equipped with 3-point belt, and cannot be used if the vehicle seat is equipped with only 2-point belt.
I	9-18kg	9months-4years old	5-point harness	ISOFIT+ vehicle's 3-point seat belt	Forward Facing 	The vehicle equipped with ISOFIX anchorages, and cannot be used if the vehicle seat is equipped with only 2-point belt.
II+III	15-36kg	4-12 years old	vehicle's 3-point seat belt	vehicle's 3-point seat belt	Forward Facing 	The vehicle equipped with 3-point belt, and cannot be used if the vehicle seat is equipped with only 2-point belt.
II+III	15-36kg	4-12 years old	vehicle's 3-point seat belt	ISOFIT+ vehicle's 3-point seat belt	Forward Facing 	The vehicle equipped with ISOFIX anchorages, and cannot be used if the vehicle seat is equipped with only 2-point belt.

⑦ Only can apply to the vehicle that has ISOFIX anchorages and 3-point safety belts.

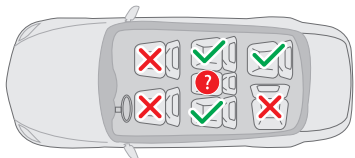

Attention

1. The installation for Group 0+ is rearward facing and is applied to children from 0 to 13kg.
2. This car seat for Group 0+ only has one sitting posture and it is level 4.
3. Baby car seat for Group 0+ can not be installed in the position which is equipped with airbag.
4. Please place the cushion for Group 0+ into the car seat when using rearward facing.
5. Important - If your child's weight is less than 9kg, you cannot make forward facing installation.

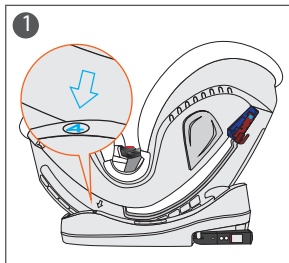

Step 1: As shown in figure 1, push the setting knob and adjust the angle of seat to the level 4.

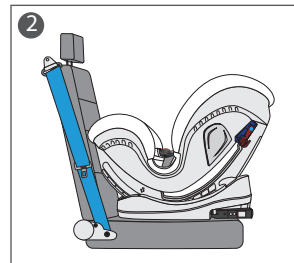

Step 2: As shown in figure 2, placing the safety car seat rearward in the car seat and make it cling to car seat back.

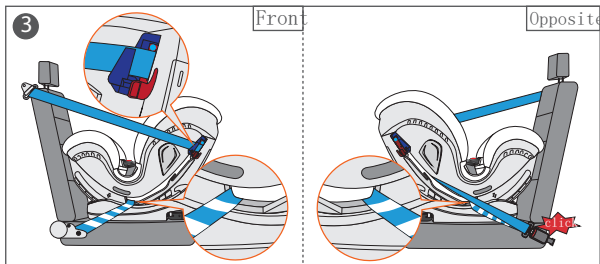

Step 3: As shown in figure 3, the car safety belt passes through the hole of the safety seat according to the blue direction. Put the car safety belt tongue into the car buckle. Pull horizontal car belt tight and place oblique car belt into locking device, then pull belt tight again. Next, put oblique car belt into guiding slot for Group 0+ and put remainder belt into seat belt retractor. Finally, shake the safety seat to ensure whether car seat is already fixed.



Attentio

1. The installation for Group I is forward facing and is applied to children from 9 to 18kg.
2. This car seat for Group I has three sitting postures and they are level 1/2/3.
3. After adjusting, make baby car seat cling to car seat back and strain safety belt.

1. UNIVERSAL I (9-18kg): 3-POINT BELT

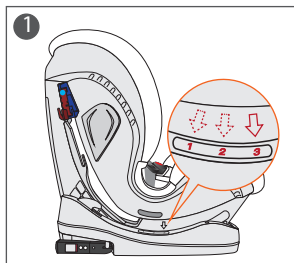

Step 1: As shown in figure 1, push the setting knob and adjust the angle of seat to the right level.

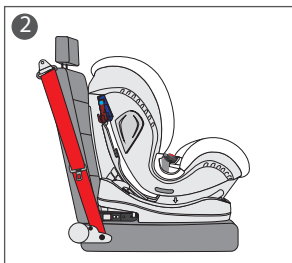

Step 2: As shown in figure 2, place the safety car seat forward in the car seat and make it cling to car seat back.

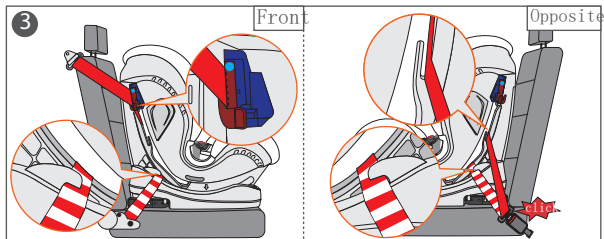

Step 3: As shown in figure 3, the car safety belt passes through the hole of the safety seat according to the red direction. Put the car safety belt tongue into the car buckle. Place horizontal car belt into limit hook tightly and place oblique car belt into Group I guiding slot, then pull belt tight again, put remainder belt into seat belt retractor. Finally, shake the safety seat to ensure it is already fixed.



2. SEMI-UNIVERSAL I (9-18kg): ISOFIT+3-POINT BELT

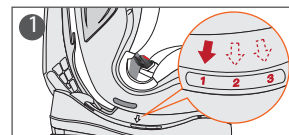

Step 1: As shown in figure 1, push the setting knob and adjust the angle of seat to the right level.

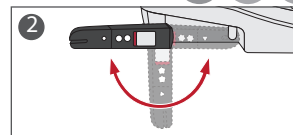

Step 2: As shown in figure 2, rotate ISOFIT connector outward, if you want to return the connector, you can rotate it back.

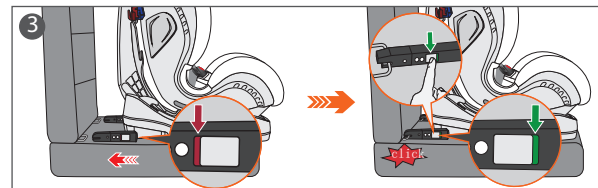

Step 3: As shown in figure 3, before inserting the two ISOFIT connectors firmly into the ISOFIX fixed point in the car seat, ISOFIT indication window will show red sign. Then, insert the two ISOFIT connectors firmly into the ISOFIX fixed point in the car seat with a clicking noise on both side. In the meantime, ISOFIT indication window will become green. In order to release ISOFIT connectors, push the white button and pull the ISOFIX releasing button, the indication window will become red.

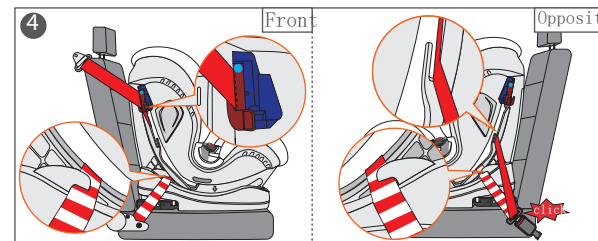

Step 3: As shown in figure 3, the car safety belt passes through the hole of the safety seat according to the red direction. Put the car safety belt tongue into the car buckle. Place horizontal car belt into limit hook tightly and place oblique car belt into Group I guiding slot, then pull belt tight again, put remainder belt into seat belt retractor. Finally, shake the safety seat to ensure it is already fixed.

Group 0+I: 5-Point Harness Installation

Group 0+I: 5-Point Harness Installation

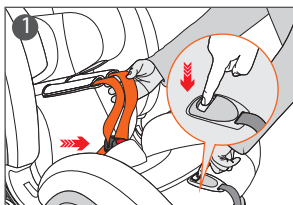

Step 1: Press the central adjuster and meanwhile, pull out the harness strap to release shoulder belt.

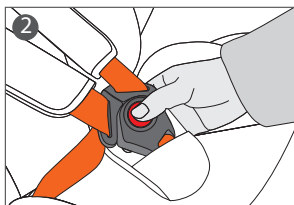

Step 2: Press the red button to open the harness buckle.

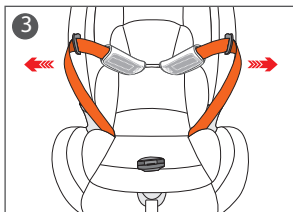

Step 3: Pull out both of the shoulder belts to both sides of the child safety seat.

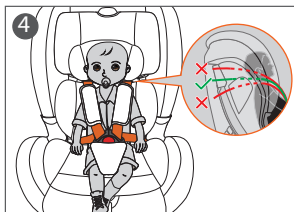

Step 4: Place your child into seat and make sure the lap belt can restrict the position of pelvis. Please check the height of shoulder belts. It is better to make shoulder belts be a little bit higher than child's shoulders.

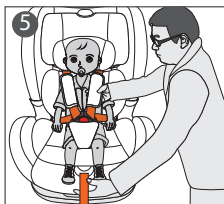

Step 5: Pull harness adjustment strap outward to fix child and avoid harness strap to constrict child too much. Adult's palm can insert between harness strap and child's chest. Make sure the tightness is comfortable for your child and ensure the lap belt restrict the position of pelvis.

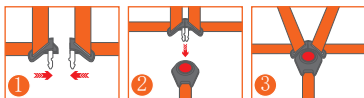

Methods to use harness buckle: Guide the two buckle latches together and engage them before putting them into the harness buckle, this should make a click nose. The buckle latches will be released if you press the red button.

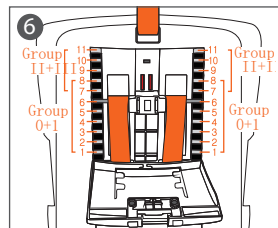

Step 6: Non-rethread harness system adjustable with headrest: according to different height of children, there are 8 levels to adjust the height of headrest and shoulder belt in Group 0+I. There are 5 levels to adjust the height of headrest and shoulder belt in Group II+III. Before adjustment, please loosen 5-point safety belt. Attention: after sitting, adjust the headrest to the right position.

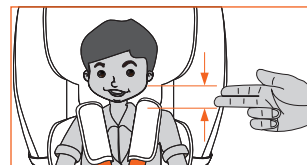

Attention: One or two fingers is the best distance from the bottom of headrest to child's shoulders.

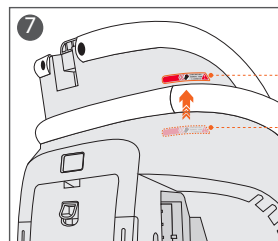

Step 7: If the red line in the side of headrest exceeds the height of side car seat body, you should use Group II+III installation.

Higher than the base line for the side car seat body

Lower than the base line for the side car seat body



The base line for the side car seat body

Group 0+I: 5-Point Harness Removal

Group 0+I: 5-Point Harness Removal

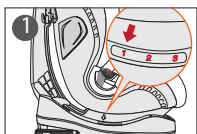

Step 1: Adjust the baby car seat to level 1.

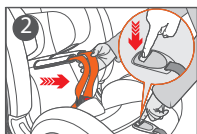

Step 2: Push central adjuster and loosen the belt. Then, adjust headrest to level 3 or level 4 or level 5.



Step 3: Separate the shoulder belt with strap yoke: Put strap yoke into the rear cover and draw out the belt forward.

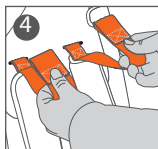

Step 4: Separate shoulder pads with belt: Draw out shoulder pads firstly, open the shoulder pads and separate shoulder belts with strap yoke, then draw out the shoulder pads.

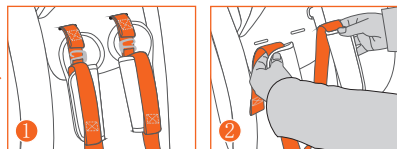

Step 5: Open harness buckle, put the buckle pad and cushion aside.

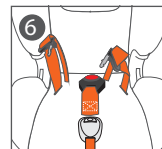
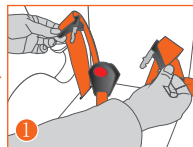

Step 6: Separate harness buckle and car seat (see 1 and 2).

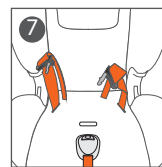
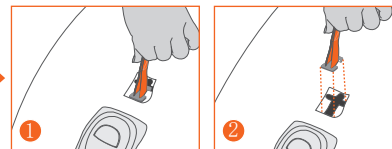

Step 7: Separate the strap with the seat: Separate strap yoke from the seat by hands or small tools. Then draw out the belt and fix the strap yoke with the strap according to picture 1-2-3-4-5.

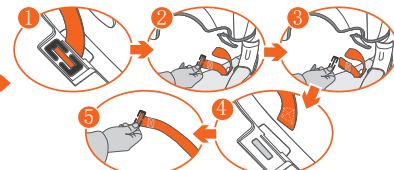

Step 8: Close the rear cover, finish the removal of the 5-point safety belt like pictures.



Notice

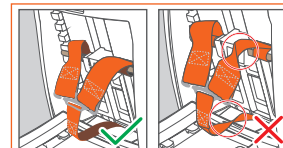

Attention: When you install shoulder belt and harness yoke, do not twist the strap.

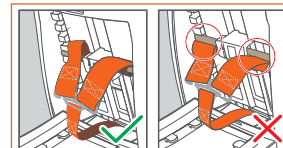

Attention: When you install shoulder belt and strap, you must make belts pass the harness shaft.



Attention

1. There is only one level for Group II+III and it is first level.
2. Before using Group II+III, please remove the 5-point safety belt and cushion.
3. Pull the belt in the buckle tightly to make sure buckle in the right position.
4. Universal installation and semi-universal installation are equipped with 3-point belt which is certified by GB14166 or ECE R16.
5. Semi-universal installation is equipped with ISOFIX which is certified by GB14166 or ECE R16.

1. UNIVERSAL II+III (15-36kg): 3-POINT BELT

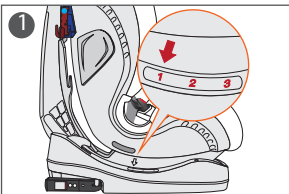

Step 1: As shown in figure 1, adjust the baby car seat to level 1.

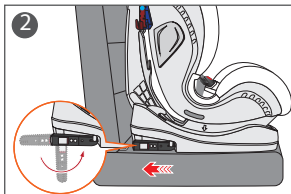

Step 2: As shown in figure 2, return ISOFIT connector, then put baby car seat to the right place.

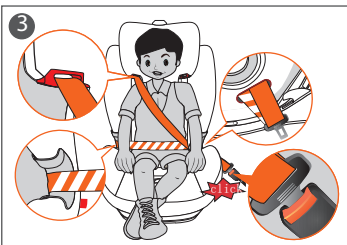

Step 3: As shown in figure 3, have your child sit on the seat and adjust headrest to the comfortable position. Then make the oblique belt through the guiding hook for Group II and III, horizontal belt through the harness guider and pass through the guiding hole. Then, insert car belt tongue to car buckle with click sound. Finally, make sure the lap belt can restrict the position of pelvis.

2. SEMI-UNIVERSAL II+III (15-36kg): ISOFIT+3-POINT BELT

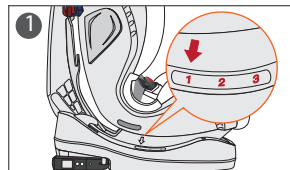

Step 1: As shown in figure 1, adjust the car seat to level 1 before installation.

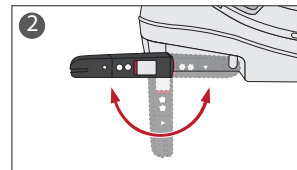

Step 2: As shown in figure 2, rotate ISOFIT connector outward, if you want to return the connector, you can rotate it back.

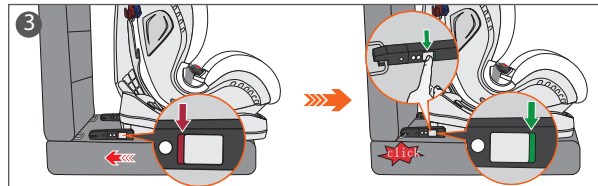

Step 3: As shown in figure 3, before inserting the two ISOFIT connectors firmly into the ISOFIX fixed point in the car seat, ISOFIT indication window will show red sign. Then, insert the two ISOFIT connectors firmly into the ISOFIX fixed point in the car seat with a clicking noise on both side. In the meantime, ISOFIT indication window will become green. In order to release ISOFIT connectors, push the white button and pull the ISOFIX releasing button, the indication window will become red.



Step 4: As shown in figure 4, have your child sit on the seat and adjust headrest to the comfortable position. Then make the oblique belt through the guiding hook for Group II and III, horizontal belt through the harness guider and pass through the guiding hole. Then, insert car belt tongue to car buckle with click sound. Finally, make sure the lap belt can restrict the position of pelvis.

Removing the Cover

1. Removing the cover of car body

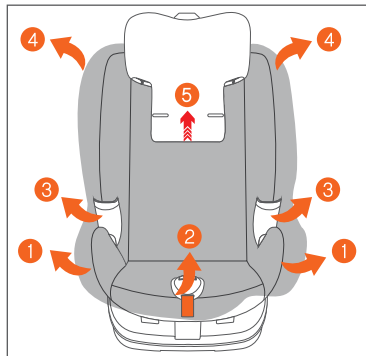

As shown in picture, remove the cover according to the order of 1, 2, 3, 4, 5.

Attentio

In the circle 2, take the cover down from the four plastic hooks in the bottom of car seat. When you refit the cover, you also should fix the cover by four plastic hooks.

2. Removing the cover of headrest

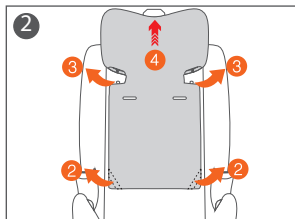
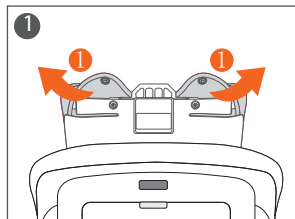

Step 1: As shown in figure 1, open the button in the headrest.

Step 2: As shown in figure 2, separate the elastic with the headrest (see point 2). According to point 3, separate elastic with the frame. Then, remove the cover as shown in Arrow 4.

Attentio When you are ready to refit, make the steps in the opposite order.

Cleaning and Maintenance

- 1 Regularly check all important parts for damage. Make sure that the mechanical components in particular are all in perfect working order. If there is damage about your child safety seat in the event of an accident, in this case the safety seat must be replaced.
- 2 Store the child safety seat in a safe, dry place when it will not be used for an extended period of time.
- 3 Brush away loose debris using a soft bristled brush to clean the safety belt and plastic components, and then ventilate or dry them.
- 4 If food or beverage drips on your seat belt, thoroughly rinse it using warm water and then ventilate or dry it.
- 5 Remove and wash the cover see the instructions of cleaning.

If wash the cover in the first time, the cover might fade a little bit, It is a normal phenomenon.

Washing Instructions

Do not use solvents, chemical cleaners and lubricants



Hand Wash
using the water
under 30°C



Do not Bleach



Do not
Machine Dry



Do not Iron