

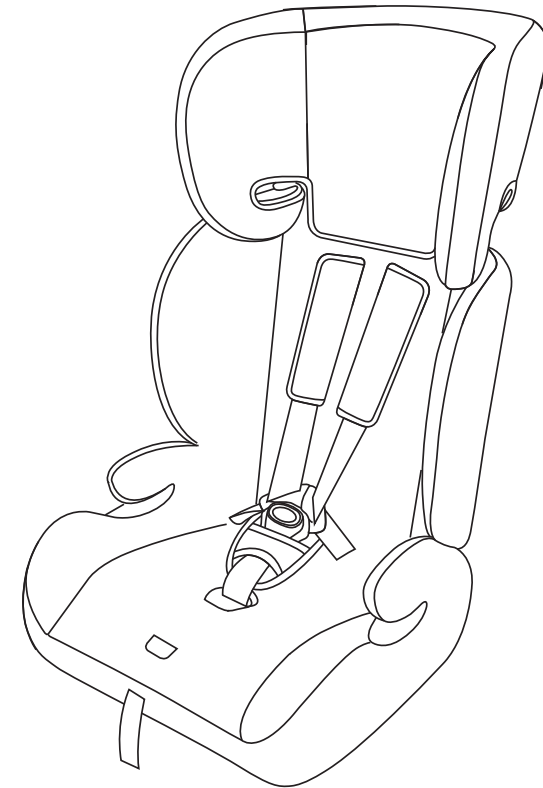

FRANCE DESIGNED

MARS

Carseat
USER MANUAL



Group
1,2,3

9-36Kg

www.jikelbaby.com

IMPORTANT
Retain for Future Reference & Read Carefully



User Instruction

Notice

1. This is a "Universal" children restraint system (CRS) which is approved to ECE Regulation No.44/04 series of amendments and GB27887-2011, for general use in vehicles and it will fit most, but not all, car seats.
2. A correct fit is likely if the vehicle manufacturer has declared in the vehicle handbook that the vehicle capable of accepting a "Universal" child restraint for this age group.
3. This child restraint has been classified as "Universal" under more stringent conditions than those which applied to earlier designs which do not carry this notice.
4. If in doubt, consult either the child restraint manufacturer or the retailer.

Warning

Please read this instruction and the relative part of your vehicle manual. Please follow this instruction while installing and using this baby car seat. Not following this instruction may lead to a severe injury or death to your child. Please keep this instruction in a safe place in case of future reading.

Note: this manual is only for reference, please prevail in kind!

Content

<i>1 Application scope</i>	<i>03</i>
<i>2 Using note</i>	<i>03</i>
<i>3 Part List</i>	<i>06</i>
<i>4 Baby car seat assembling and functions</i>	<i>07</i>
<i>5.Usage of Group 1 Installed</i>	<i>08</i>
<i>5.1 Belt installation</i>	<i>09</i>
<i>5.2 Fixation of Group I Children</i>	<i>10</i>
<i>5.3 Fixation of 5-point harness</i>	<i>10</i>
<i>6.Usage of Group 2 - 3 Installed</i>	<i>12</i>
<i>7.Usage of Group 3 Installed</i>	<i>13</i>
<i>8.Maintainance</i>	<i>14</i>
<i>8.1 Attention</i>	<i>14</i>
<i>8.2 Cover cleaning</i>	<i>14</i>
<i>8.3 Removal of the fabric cover</i>	<i>14</i>
<i>8.4 Installation of the fabric cover</i>	<i>15</i>

1. Application scope

Certificated by ECE R44/04 and GB27887-2011, this baby safety seat is applicable for Group 1-2-3.

Baby safety Seat	Group	Range of baby weight
Mars	1-2-3	9-36kg

Certification

- This baby safety seat is designed and tested with the European Children Rstraint System standard (ECE R44/04) and the Chinese Children Rstraint System standard (GB27887-2011). The certification stamp E mark (in the round circle) with approval number.
- Any modification of this seat by you will lead to invalidity of the certification. Nobody is authorized to modify baby safety seat unless the baby safety seat manufacturer.

2.Using note

Warning

- Please read this instruction very carefully before using this car seat. Not following this instruction may leads to a injury to your baby.
- Using car seat correctly is very important to your baby.
- Please keep the instruction and collection bag well of convenience in the future.
- Do not leave your baby alone in this baby safety seat in your car.
- Installeing to a seat of your car which has a SRS system is forbidden..

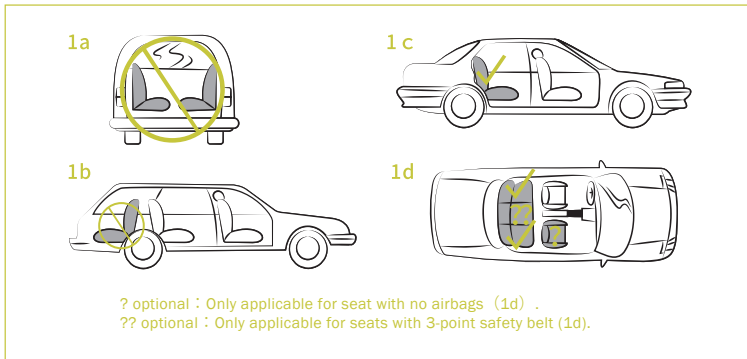

- DO NOT use this seat on side-facing or rear-facing car seats(image 1a,1b).Only applicable for front-facing car seats.Crash statistic shows that children are safer in back row seats.(image 1c,1d)
- Do not use this car seat in seating positions where an active frontal airbag installed,better install to the back seat of the car.
- Only suitable if the approved vehicles are fitted with 3 point safety-belts with retractor, approved to UN/ECE Regulation Np.16 or other equivalent standards.
- After crash accident, the damage of the the baby car seat may not be found instantly, but it is not safe any more, therefore, please change a new one.
- The car seat must be fixed well, even there is no baby in the car, because it may hurt other passengers in case of crash or a sudden brake.
- Do not use any lubricant to the moving parts of the car seat.
- Do not use the car seat without cloth cover. Please return the cloth cover to the original state after leaning.
- Do not refit the car seat, because it will change the safety performance of the carseat.
- Do not expose the car seat to burning sun, the metal and plastic parts of the car seat may be brning hot. Please check the temperature of the car seat before fixing baby to avoid hurting baby. Also burning sun may fake the color.
- Please tell your baby not to play with the buckle.

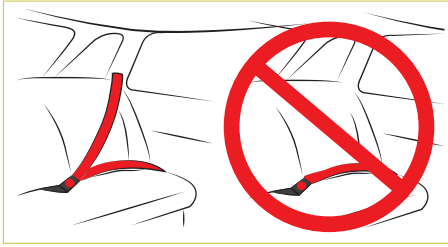

Danger

- 2-point car belt is forbidden to fix your baby.
- Please install the car seat and parts correctly according to the User Instruction, to ensure car seat not stuck by the door or seat of car.
- Belt should be installed correctly, ensure the belt be in the pelvis.
- No twine or twisting of the belts.
- Car seat must be changed after strong crash.
- Car seat without our certification and user instruction or refitted is very dangerous.
- Do not leave baby alone on the car seat.
- Luggage and other items should be properly placed after car crash.
- Car seat without cloth cover cannot be used, cloth cover not provided by manufacturer cannot be used, it influences the performance of car seat.
- Force bearing point unmarked cannot be used when installing, any doubt please contact manufacturer or the retailer.

3.Part List

- 1- Headrest
- 2- Central adjuster button
- 3- Shoulder pad
- 4- safety belt
- 5- Buckle
- 6- Crotch pad
- 7- car seat belt guide groove
- 8- Central adjuster button
- 9- adjusted belt

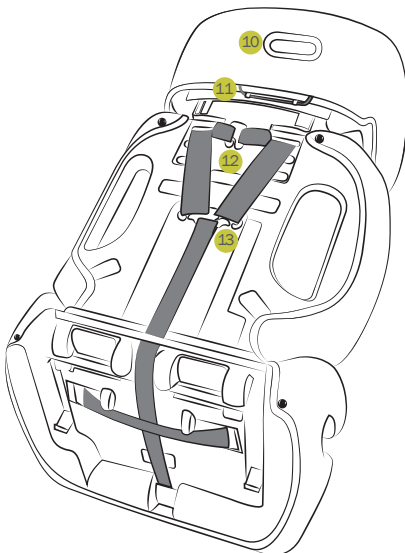
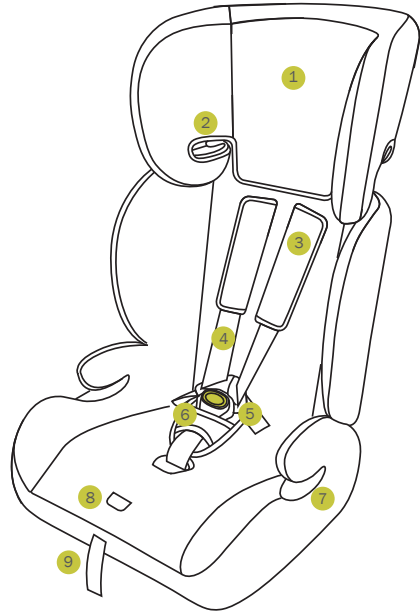

- 10- Headrest adjuster
- 11- Upper elastic strap
- 12- Polypropylene shoulder strap mounting clamp
- 13- Strap connecting plate

4. Baby car seat assembling and functions

1- To assemble the seat, insert the headrest into the slot on top of backrest (Figure a)

2- Hold the backrest and put the two hooks on backrest to the slots in the base (Figure b), then push the backrest till vertical (Figure d).

3- To disassemble the seat, simply push the backrest backward (Figure c).

Note: Fold the seat when not using it for space saving.

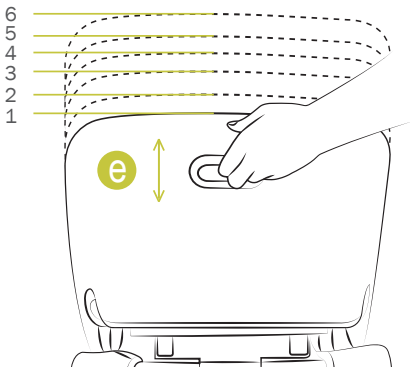
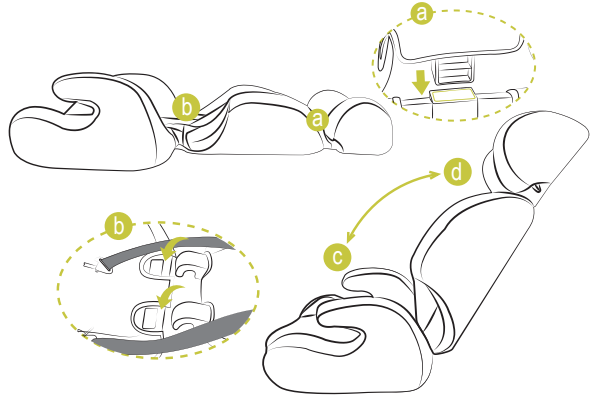

Use the headrest adjuster to lift the headrest into an appropriate height. (Figure e)

Caution:

- 1- The headrest height has 6 levels.
- 2- Before use the baby car seat, please adjust the headrest until of the upper belt rout guider and the child's shoulder are at same level.

5.Usage of Group 1 Installed

(Suitable to 9-18kg, 9 months-4 years' baby)



Forward facing installation

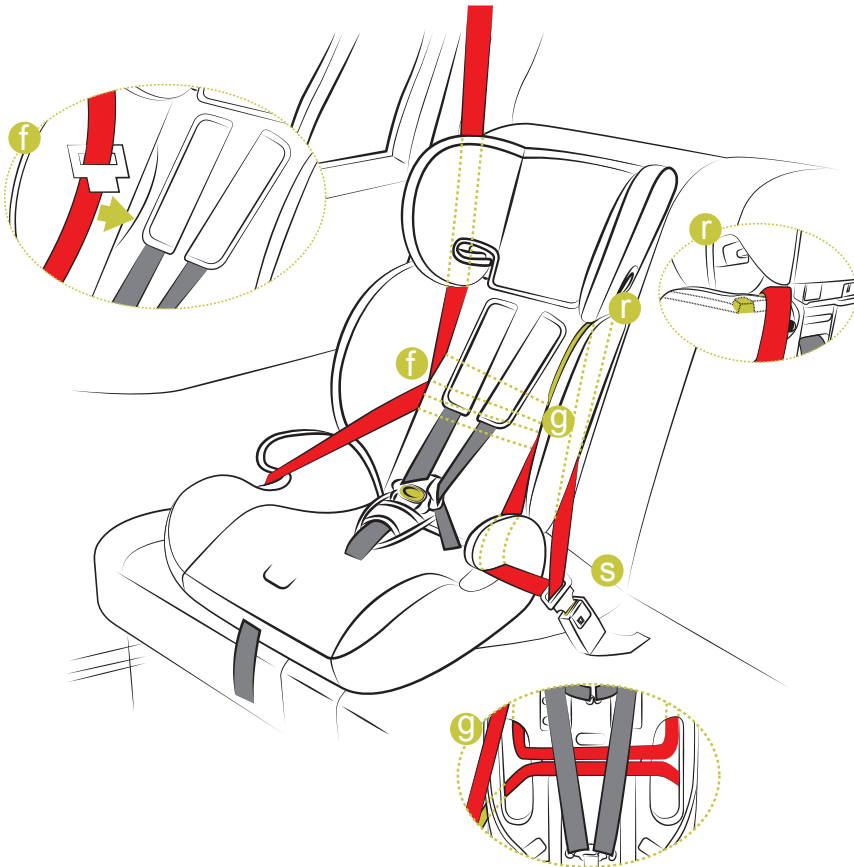

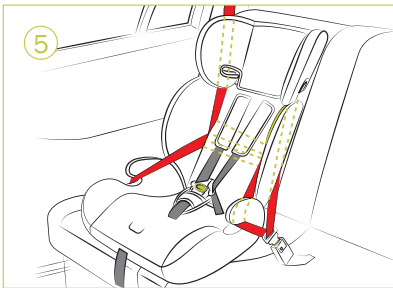
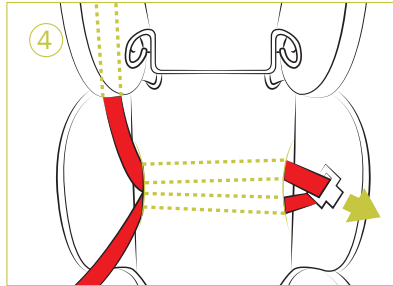
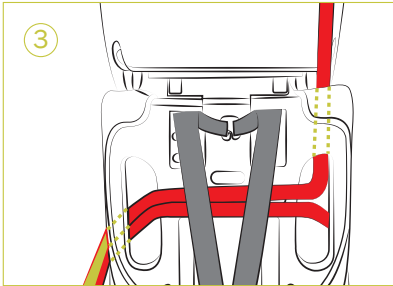
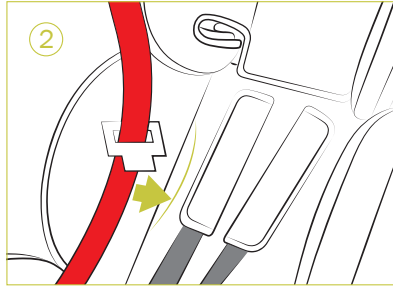
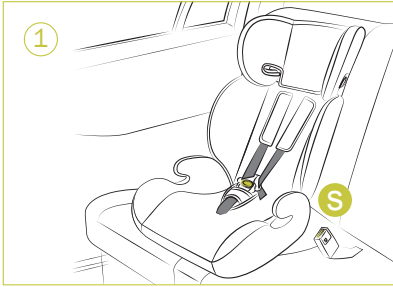

near-end (Figure 2).

- let the belt go through backside of the backrest and draw it out of the belt passage on the other side (Figure 3,4).

Note: The car belt must go under the straps of harness system.

- Make sure the car belt go through the belt guide groove, then buckle it on and fasten (Figure 5).

5.1 Belt installation

- Put the baby car seat onto vehicle seat.(Figure 1)
- Pull out the car belt, let the belt tongue go through the belt passage at

5.2 Fixation of Group I Children

(Suitable to 9-18kg, 9 months-4 years' baby)

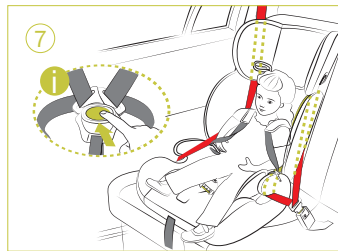
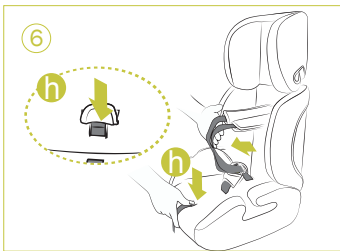
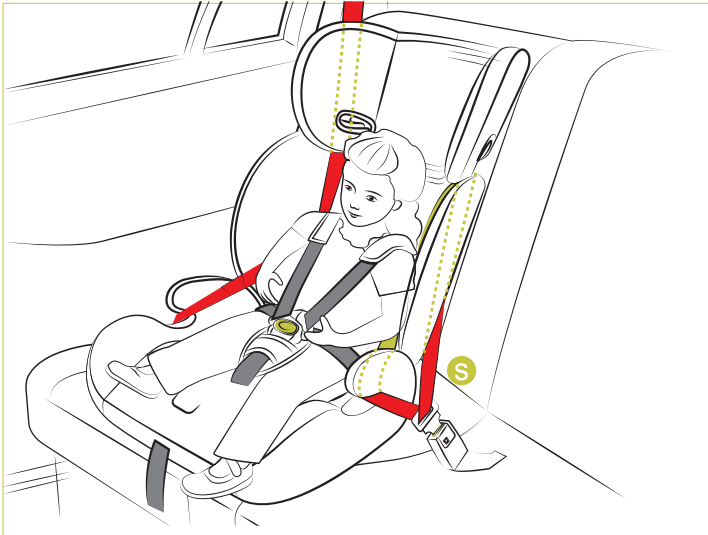

5.3 Fixation of 5-point harness

- Extend the safety belt ----- Push the central adjuster with one hand (Figure 6 h), pull outward the safety belts with the other hand (**caution! do not pull the shoulder pad**)
- Press the red button on the buckle to release it until hearing the "click" sound(Figure 7i), put the child into the baby car seat, let his/her arms go through the safety belt.(Figure 7)

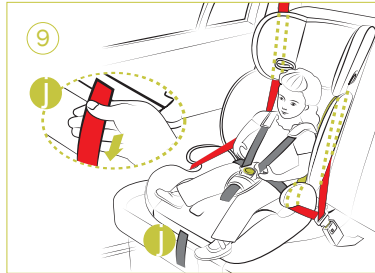
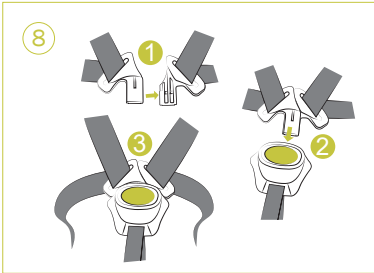

- Put the two buckle tongues together and insert into the buckle until you hear a "click" sound. (Figure 8)

- Draw the adjusting strap forwardly to fasten the harness system (Figure 9 j).

Caution: The proper tightness is one finger space between the safety belt and the child's body. Correct position of the buckle is at the crotch of the child not his/her belly.

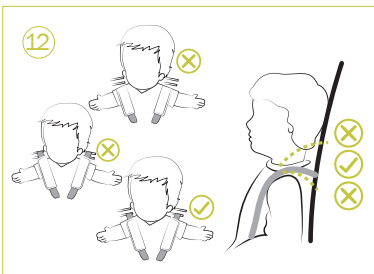
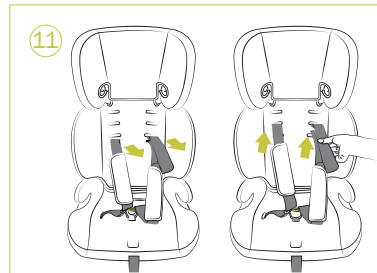
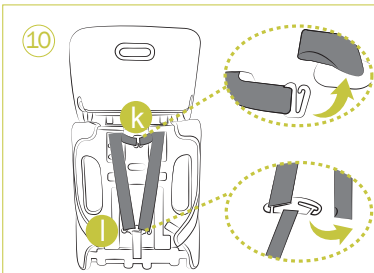

- Remove the straps from strap connecting plate (Figure 10 i). Detach the shoulder strap from the connecting clamp.

- Pull out and re-install the belt and shoulder straps in the slot at appropriate level. (Figure 11)

- Make sure the shoulder belt is even and a little bit lower than the child's shoulders. (Figure 12)

6.Usage of Group 2 - 3 Installed

(Suitable to 9-18kg, 9 months-4 years' baby)



Forward facing installation

Caution:5-point harness system must be removed in group 2 - 3 usage.

(Refer to Page 14 Figure 13,14)

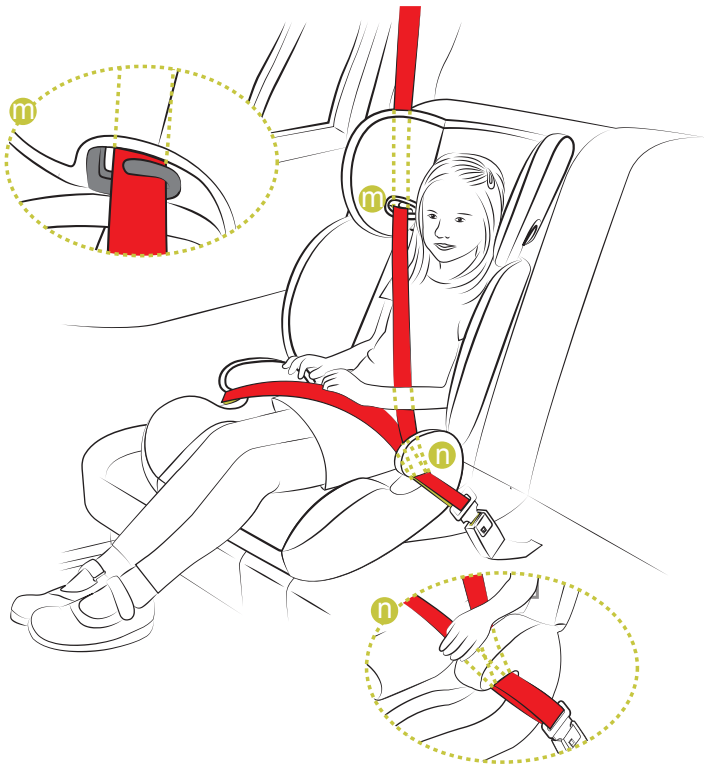

7.Usage of Group 3 Installed



Forward facing installation

(Suitable to 9-18kg, 9 months-4 years' baby)

Caution:5-point harness system must be removed in group 3 usage (Refer to Page 14 Figure 13,14).
Backrest and headrest must be removed (Refer to Page 15 Figure 15) as well.

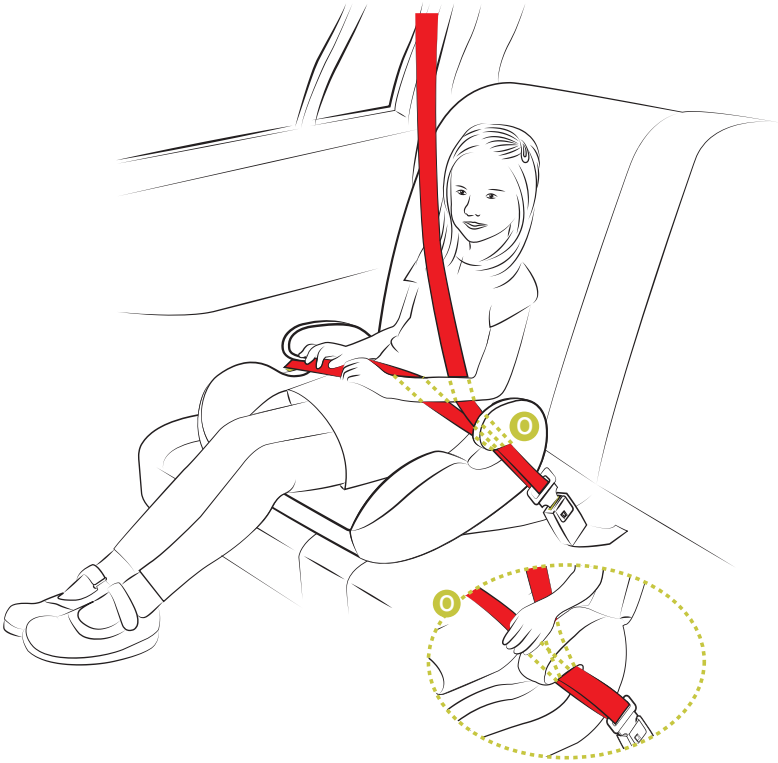

8.Maintenance

8.1 Attention

- Accidents happened when the car speed higher than 10km/h,may cause invisible damage to the baby safety seat.Please change your baby safety seat after crash accident.
- Check all important parts regularly, make sure all mechanism functions properly.
- Do not lubricate any part with lubricants.
- To avoid damage, make sure no part of this baby seat is stuck by car door, foldable car seat or any other objects.

8.2 Cover cleaning

⚠ Do not use baby car seat without cloth cover.

- Cloth cover can be removed.Wash it with a mild detergent in warm water(water temperature does not exceed 30C), natural dry, not dehydration.
- Plastic parts can be cleaned with soap and water, do not use strong detergents (such as solvent).
- Shoulder strap can be removed with mild soap water to clean.

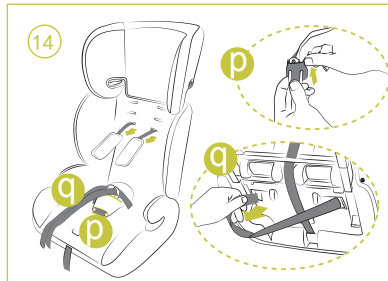
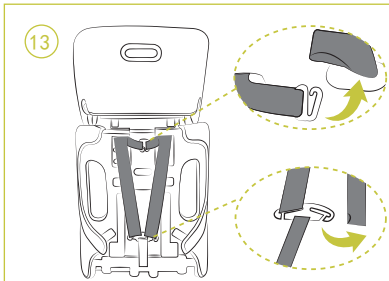

8.3 Removal of the fabric cover

- Remove the straps from strap connecting plate . Detach the shoulder strap from the connecting clamp.(Figure 13)
- Pull out the shoulder pad and belts on front side, then remove all ladder buttons of the crotch strap in bottom.(Figure 14)

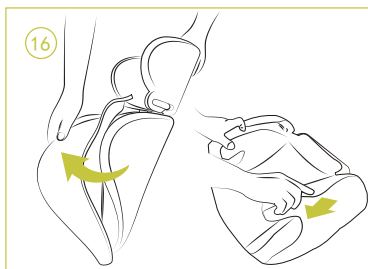
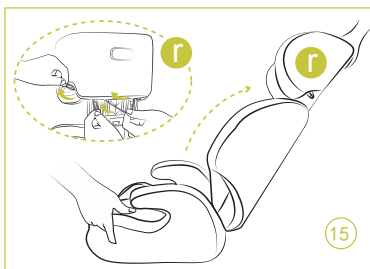

- Release the black elastic bands (Figure 15 r). To disassemble the seat, press and fix the base with one hand and push the backrest with the other hand (Figure 15).
- Open the snap buttons on fabric cover to remove the whole cover(Figure 16).

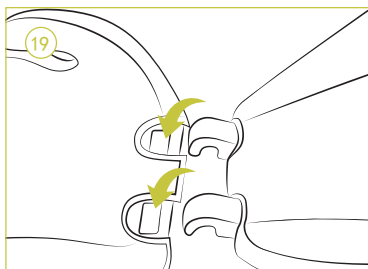
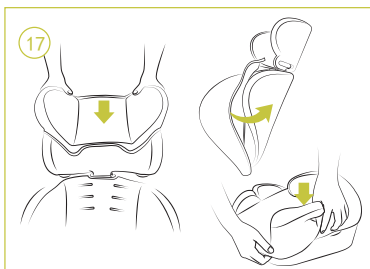

8.4 Installation of the fabric cover

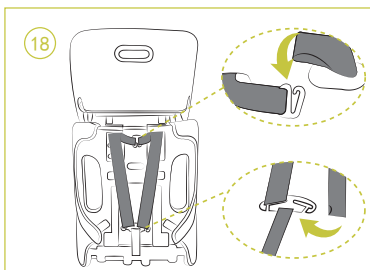

- Put the cover back onto the shell and fasten it (Figure 17).
- put the two hooks on backrest to the base slots, then push the backrest till vertical(Figure 18).
- Attach the belts onto the connecting plate and connecting clamp(Figure 19).